

## Gate Operators

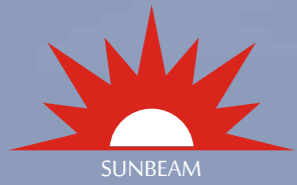

Website

Version 2018.05



# SUNBEAM

High-security, Smart, Rugged, Wind Resistant Gating Systems

SUNBEAM is a brand name of Golden Mountain Machinery Co., Ltd., which is one of the early pioneers and modern-day innovators of Gating Systems for home and office facilities. Established in 1973, SUNBEAM's award-winning products include **Roller Shutter Motors, Roller Shutters, Smart Strong-Wind Resistant Roller Shutters, Speedy Roller Shutters, Fence Sliding Gate Operators, and Smart Collapsible Gates**, all of which are developed and produced in our **ISO9001 certified, 8,983 square-meter office and factory facilities**, operating out of **Central Taiwan**.

SUNBEAM's staying-power is firmly entrenched in a culture of attention-to-detail and reinvention, introducing new services, materials and technology to help focus on raising the standards on **smart, rugged, long-lasting gating solutions**. SUNBEAM technologies have secured countless patents across Taiwan, Europe, America, Malaysia and Japan, and has garnered generous subsidies from the SBIR (Small Business Innovation Research) for the advancement of new technologies for the Gating Industry.

## Local/International Patents



Each of our product lines are the culmination of many years of professional experience and technology evolution that are backed up by a long list of patent certificates and decorations, both locally and internationally - it is a testament to our dedication and commitment to bring new directions and ideas to the Gating Industry.



Golden Mountain Established by President HUNG, CHIN-SHAN

Moved to first factory and office complex

ISO 9001

Launched new second factory

Strong-Wind Resistant Roller Shutter technology 20-year patent (MOEA subsidized)

Launched Speedy Roller Shutter Factory

1973

1991

2001

2007

2016

1987

Far Eastern Asia Invention Fair Award Winner

1992

Upgraded factory to accommodate expanding business

2005

Launched Smart Fence Sliding Gate Operators (MOEA patent and subsidies)

2014

Launched Speedy Roller Shutters

# Features

## SUNBEAM Solutions with Purpose

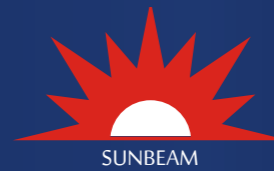

Sunbeam Gate Operators are built to complement your Entryway Gate products with Versatile Configurations, Convenient Control and Safe Operations. Our products can easily adapt to special features on your Gating products as well as boosting value with our own add-on features. Our Gate Operator advantages focus attention on what our customer need the most, which is a easy-to-use, long-lasting solutions that you don't have to worry about.



### Diversity

#### Single Sliding Gate Operator

Can be installed with Single or Dual Rails, using either Gear Rack or Chain transmission

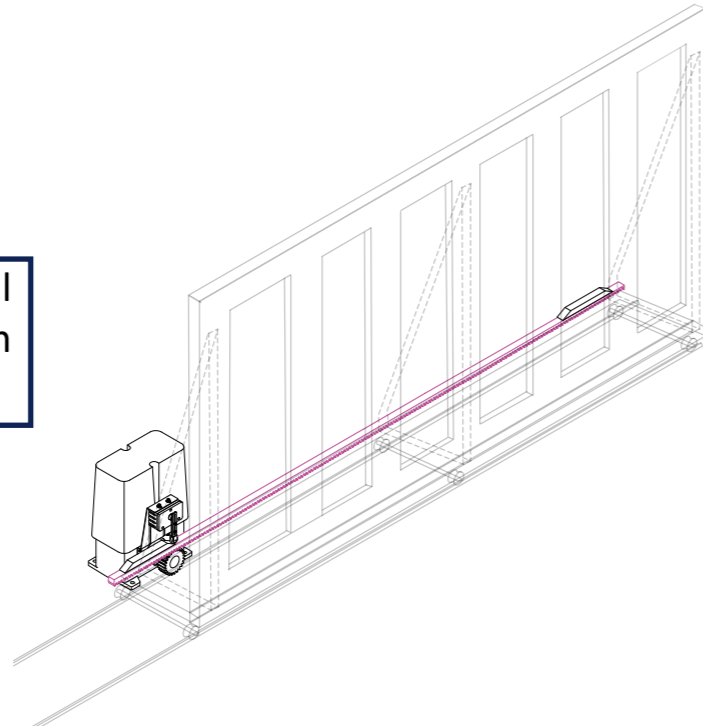

#### Dual Sliding Gate Operators

Uses dual Gate Operators to open and close gate from both sides.

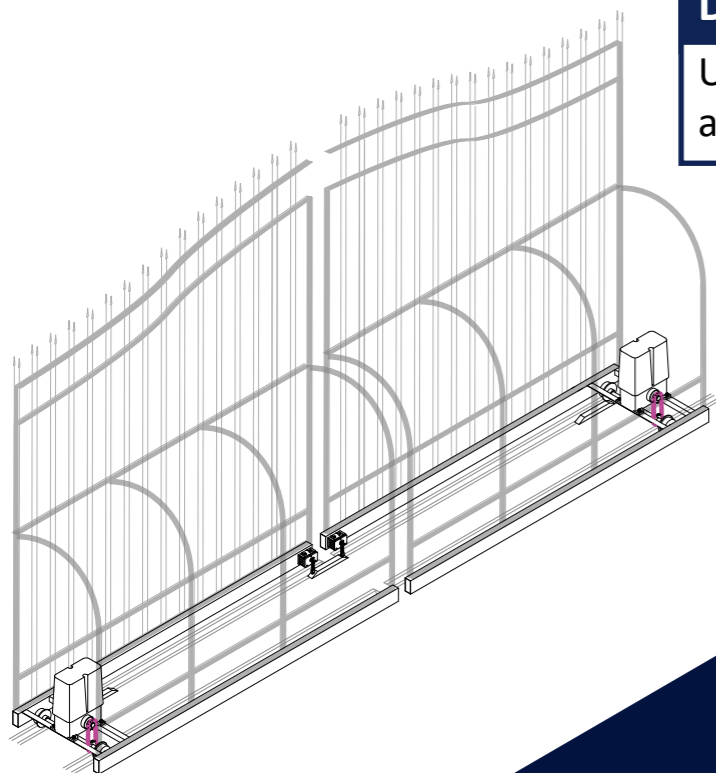

### Convenience & Safety



Off-site Cellphone Control and Office Control Center (optional)



Remote Control Access (optional)



Land-line Remote Operations



Optional circuit board provides enhanced operations and functionality



Easy clutch release in case of power outage.

Assorted bracket plates help secure components and makes installation fast and easy.



Base Platform gives Gate Operator added height elevation and/or a stable platform on soft surfaces such as soil.



Alarm/Warning Lamp



Audible Alarm



Infrared safety trip sensors

Gate Operator



# GA (single or dual rail)

## ■ Fixed to Ground - Chain Type

The GA Gate Operator is fixed to the ground and employs a 3-sprocket transmission, pulling on a chain attached to the gate, moving it in both directions. A limit switch (on Gate Operator) and limit bumps (attached to gate base) limit the extent of gate movement in either direction.

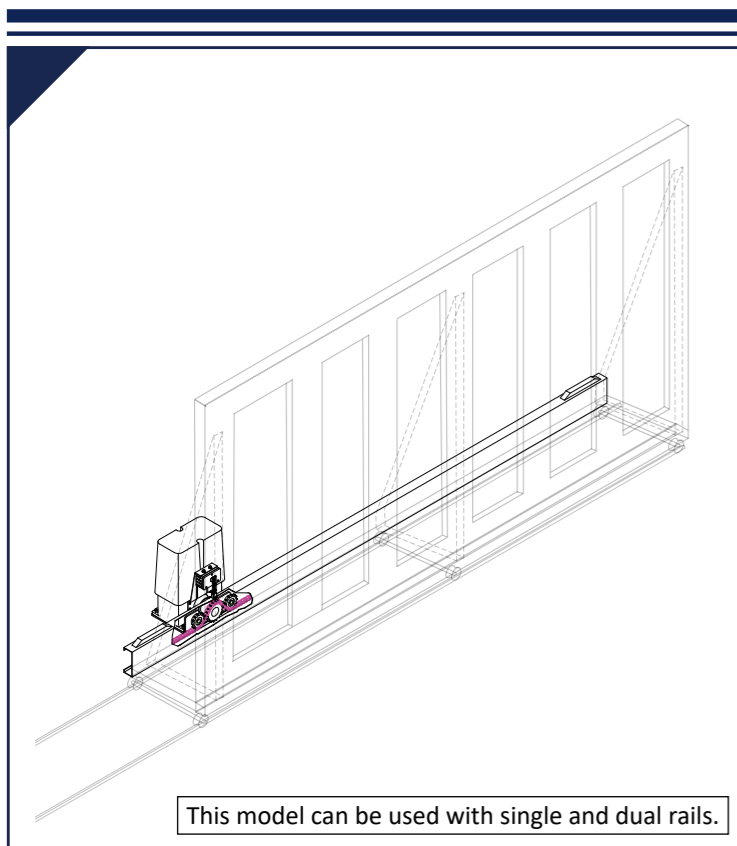
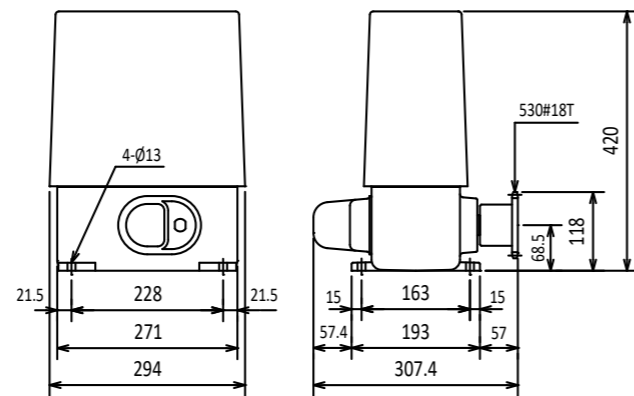
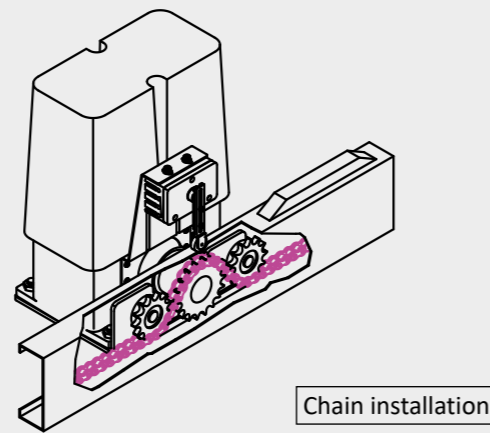
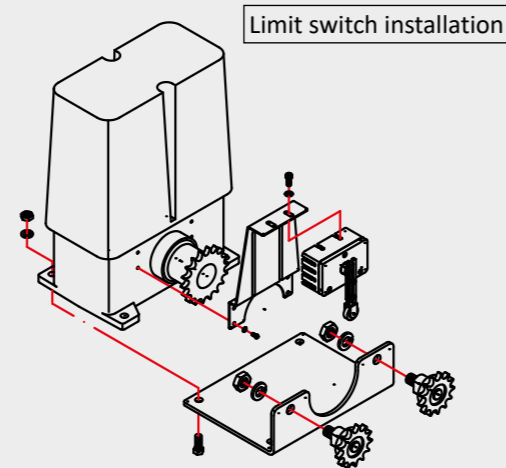

Gate Operator



# GB (single or dual rail)

## ■ Fixed to Ground - Gear Type

The GB Gate Operator is fixed onto the ground and employs a gear rack, which is attached to the gate and runs the entire length of the gate. A single sprocket on the gate operator turns and pulls the gear rack in both direction. A limit switch (on Gate Operator) and limit bumps (on gear rack or on covering of gear rack) limit the extent of gate movement in either direction.

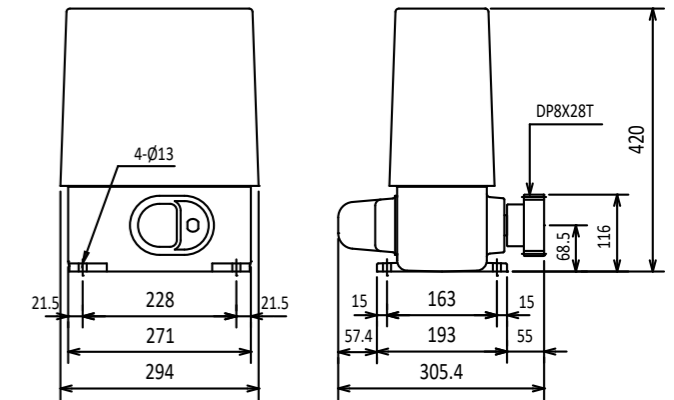
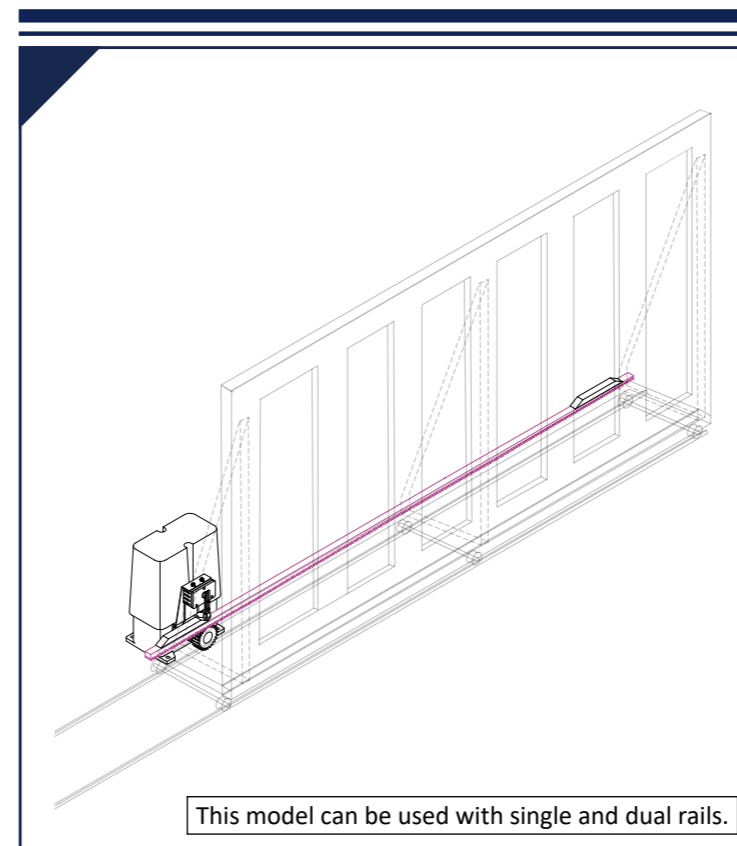
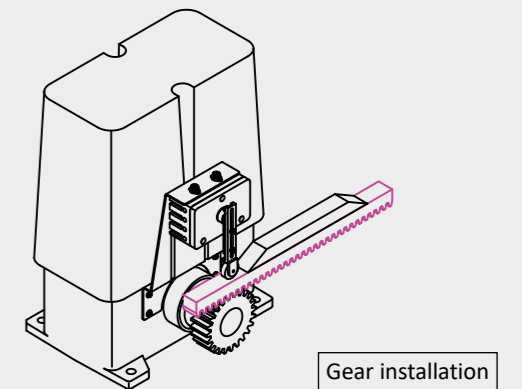
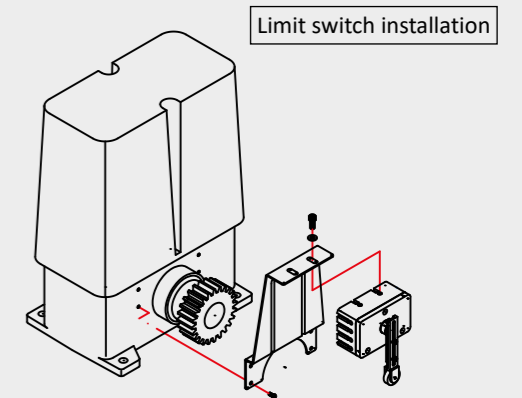



## GT (dual rail)

### ■ Fixed to Gate - Chain-type

The GT Gate Operator is fixed to the gate itself and uses a sprocket attached to a circular chain which turns the axle/wheel assembly underneath, which then pulls the gate along the tracks laid onto the surface ground (the tracks run twice the length of the gate). A limit switch is attached to a portion of the gate and stops the gate when it hits either limit bump fixed onto the ground at both ends of the tracks.

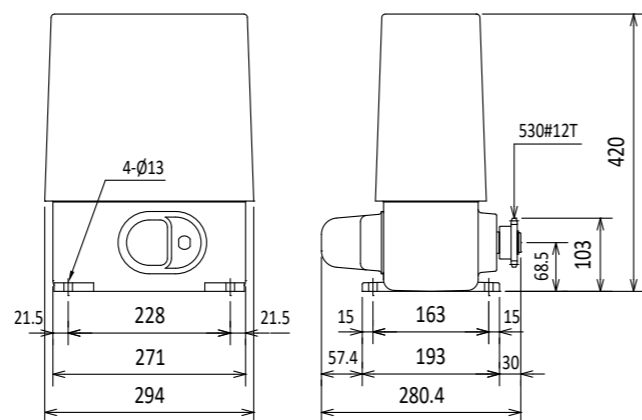
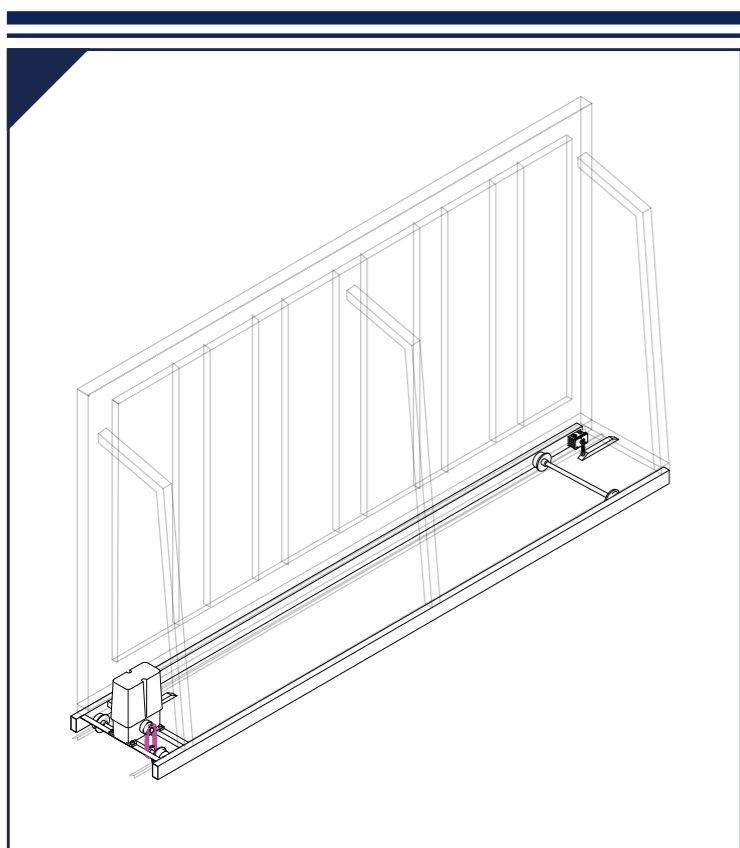
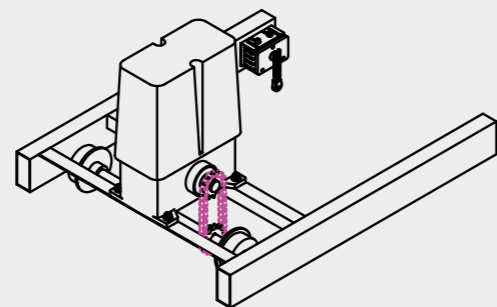
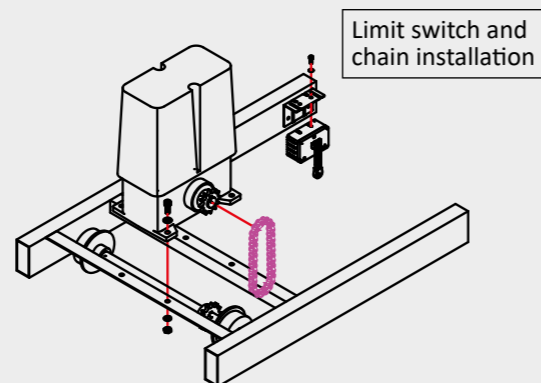

## ■ Magnetic Contactor or Circuit Board

All of our Gate Operators can be equipped with either a **Magnetic Contactor** or a **Circuit Board**.

Using a Magnetic Contactor means that it is designed with a traditional electrical system that has simple wiring and operations.



These products can be otherwise installed with a **Resistance Sensor Circuit Board** (instead of magnetic contactor), which provides a safety mechanism that can stop a moving gate when there is any drag or resistance coming from any part of the gate (front, sides, below etc.), as opposed to other sensors which are attached only to the front end of the gate. The Circuit Board does this by measuring this resistance through its gear sprocket and transmission.

Other advantages to the circuit board are easier adaptation to special devices and user features - it also has DC 12V circuitry, providing a safer environment during repairs.

Resistance Gate Operator	Other Gate Operators
<b>Front/Rear Resistance Sensing function</b> Halts a gate if any resistance is sensed from any part of the gate. No additional touch sensor strip/bumper required.	Separate touch sensor strip or bumper is required and can only "sense" at the bumper region - also requires additional cabling. Safety problems can arise when there is loss/lack of power.
<b>Touch Sensitivity</b> Adjustable resistance sensitivity can be set to one of ten sensitivity settings.	If installed with touch sensing device, it is usually limited to only one sensitivity setting.
<b>Partial Gate Open settings</b> Gate Operator can be set to open gate to a secondary partial open position at a preferred distance - no additional devices or costs are required.	Not implemented. Can add-on 3rd party devices with additional costs.
<b>Telephone Remote control for Opening and Closing of Gate</b> Functionality can optionally be configured onto the circuit board. Can connect to an Intercom or Switchboard.	Not implemented. Can retrofit with 3rd party components, wiring, while adding to costs.
<b>Infra-red trip sensor</b> - senses approaching objects and halts gate. Can use either single or dual IR sensors (front/back). When sensing an object and gate is closing, gate will stop and open fully. When the gate is opening, it will not stop the gate.	Not implemented. Can add-on 3rd party devices but risk safety issues.
<b>Safety Mode Setting</b> When encountering an object with IR Trip Sensor or Surround Resistance Sensor, Gate Operator can either stop gate or reverse directions for 3 seconds.	Not implemented.
<b>Auto Close Timer</b> - Closes gate after configurable period of time (0-240 seconds)	Not implemented. However, 3rd party components can be installed increasing costs and installation time.
<b>Gate "Travel Time" safety mechanism</b> Stops gate when it exceeds normal travel distances.	Not Implemented. Additional 3rd party components can be added with costs.

## Gate Operator Specification Sheet

All of our Gate Operators can handle assorted load bearing capacities and cater to different voltage requirements. See table below.

Load		Voltage		
500 kg	2000 kg	1Ø110V	3Ø220V	3Ø440V
1000 kg	3000 kg	1Ø220V	3Ø380V	Others

Voltages can be customized for your region

## Other reliable, long-lasting SUNBEAM Products

Touch stop safety slat



### Intelligent, Durable Wind-Resist Roller Shutters

- Touch-stop bottom safety slat
- Strong-wind resistant wheel hooks
- Fire sensor (auto door open or close)
- Anti-jamming guide rails within guides
- Anti-friction plastic wheels between slats and guide rails
- Circuit board smart applications
- Low noise

Safe

### Wind-Resist Speedy Roller Shutters

Fast

- Durable, break-resistant slats
- Hook wheels keep shutters on tracks in strong winds
- Remote control can switch door to manual operations (from inside or outside)
- AC brake motor makes forced entry impossible
- Motor is located at the inside corner of axle housing for easy access



### Roller Shutter Motors

Electro-Magnetic Brake System

- No need for Brake Coil or Commutator

Low Maintenance



### Collapsible Gates

Rugged

- Touch-stop safety device
- Stop-lock enforced security
- Stainless-steel construction
- Slip-less rail wheels
- Stainless steel needle roller bearings (in wheels)
- Partial openings
- Telephone remote control
- Auto-close (optional)
- LED fault indicators
- Strong-wind hook wheels

Golden Mountain Machinery Co., Ltd. reserves the right to continue to improve our products, and make modifications and deletions from current specifications without prior notification.